

Hawk Construction

The Beauty of
Precast

VERTI-CRETE

Screen Walls Worth Looking At

Beauty in the Look, Price and Delivery

This is just beautiful. That's sure to be the sentiment of everyone who passes by and views a new Verti-Crete screen wall. But the most beautiful aspect is that you know about the wall's superior value and strength. Only Verti-Crete walls provide the real look of stone at an affordable price with an amazingly quick installation.



Ashlar

The Look of True Masonry and Stonework

The classic look of a mason's work complements any surrounding with Verti-Crete's striking selection of realistic designs to choose from. Verti-Crete's custom designed molded textures are so realistic, that you will see every detail that you would expect to see from a mason, right down to the grout and joints. Our proprietary method of vertically casting panels and columns allows not only for a beautiful aesthetics on both sides of the wall, but also seamless stone patterns that wrap around each post corner.

To create the realistic design after installation, installers pressure wash the wall and then a base color is applied with an airless spray gun. Then accent colors are applied to individual stones to create the subtle yet realistic look of actual masonry. Virtually limitless combinations of base and accent colors can be applied to match the theme of any project.



Brick



Ashlar



Brick



Durango



Ledge stone

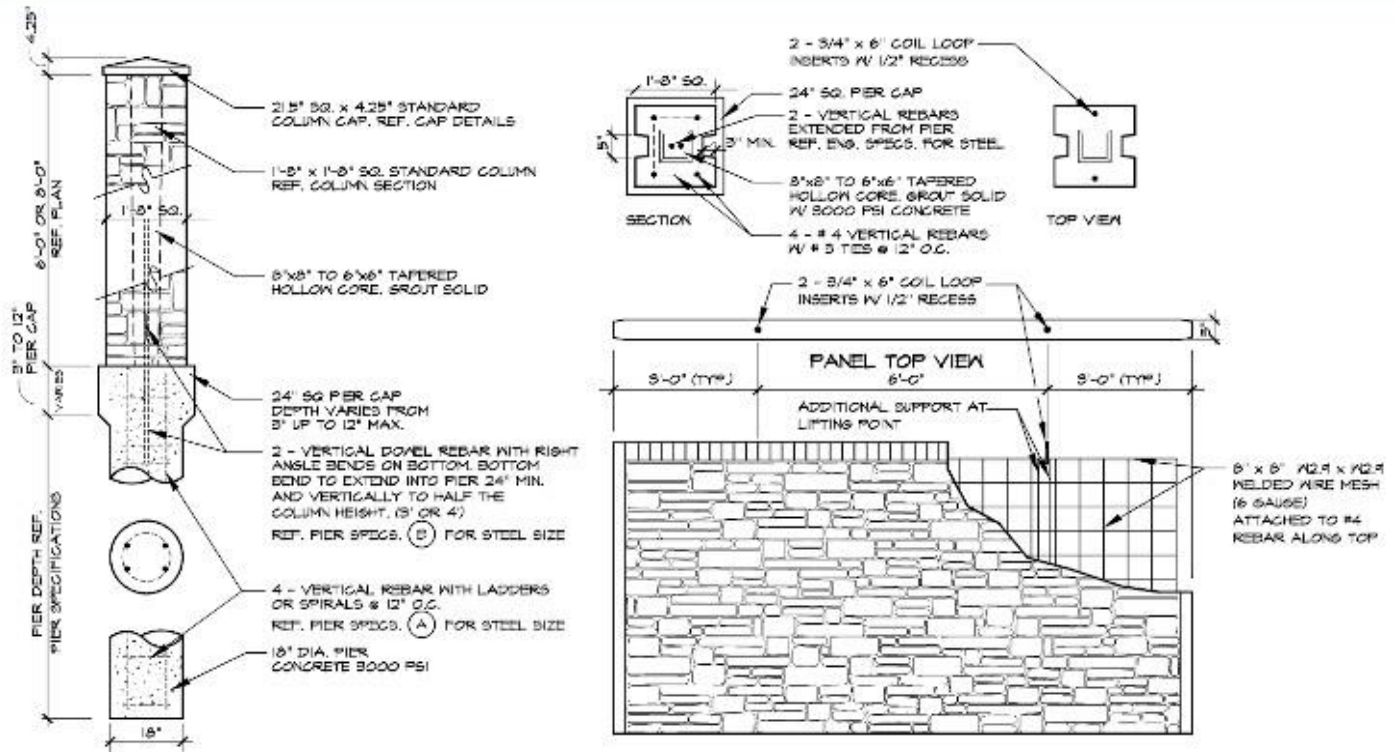

The Value of Precast

Verti-Crete walls are constructed of precast concrete for unmatched durability and consistent quality. Our proprietary vertical system design outperforms traditional cast methods by dramatically improving product quality and functionality while actually reducing production and installation costs. You will receive a molded stone pattern on both sides of the wall with the look and feel of real masonry at a fraction of the cost.

Beauty aside, Verti-Crete products are also more durable than wood, vinyl, or even brick or block walls. Our seamless solid-panel design provides structural strength and security that will last for decades. Moreover, Verti-Crete walls can be engineered to meet the building code requirements of any area. From seismic concerns to hurricane wind loads, Verti-Crete walls are designed to endure the harshest conditions and broadest range of climates.

The Ease of Installation

One of the things Verti-Crete customers like most about our walls is what they don't see, specifically, a construction crew and equipment on their property for weeks on end. Our unique design streamlines the installation process and allows for incredible flexibility in configuration. Unlike the hassle of precisely digging, maneuvering, and setting traditional H-posts, Verti-Crete posts are installed over footings with rebar anchors. After the footings are set, Verti-Crete's hollow-core posts are set over rebar to rest firmly on each concrete base. Panels are then set in place to fit securely within notches cast into the the posts. After each section is plumbed and leveled, the columns are filled with grout to secure the connection between posts and footing. This process results in a faster installation and the most cost efficient and secure connection available.



Ledgestone



Durango

Product	Dimensions
6 Ft Panel	6' x 12' x 5"
8 Ft Panel	8' x 12' x 5"
10 Ft Panel	10' x 12' x 5"
Taller	Contact for Info
-----	-----
Columns	20" x 20" x Panel Height

Hawk Construction

Contact us for a Free Quote

5002 Highway 380
Princeton, TX 75002
(972) 547-6652 Phone
(972) 542-0201 Fax

<http://hawkprecast.com/>
tv@hawkprecast.com



20' Ledgestone